

Getting Started Guide

Tobii Dynavox Speech Case



tobiidynavox

What's in the Box?

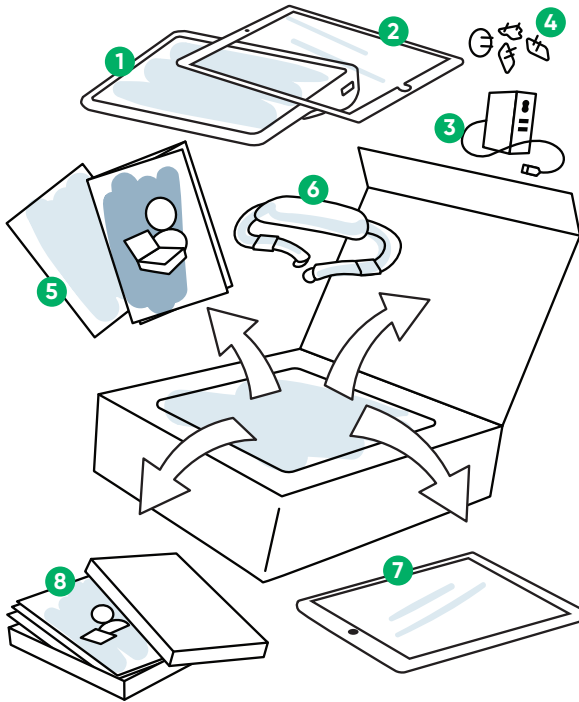

- 1** Speech Case
- 2** iPad Frame Cover
- 3** Power Cable
- 4** USB Power Adapters
- 5** User Manual
- 6** Carry Strap

Additionally, with SC Tablet:

- 7** iPad
- 8** Snap Training Cards



If you purchased a mounting plate or keyguard, see the included instructions for detailed information.

Getting to Know Your Device

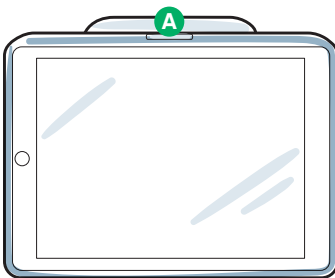

Front

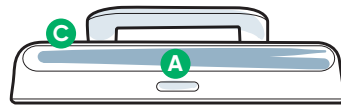
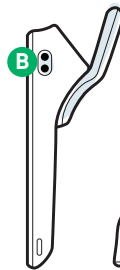

Top & Sides

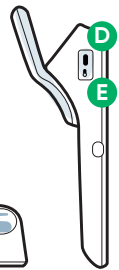

- A** Volume Rocker Switch
- B** Switch Ports

- C** Speakers
- D** Power Port (USB-C)

- E** Access Method Selector

Complete the four steps in this guide to set up your Speech Case/SC Tablet.

Before You Start

i

If you purchased the SC Tablet (Speech Case and iPad bundle), turn on the iPad and follow the on-screen instructions.

Step 1: Place iPad in Speech Case

- 1 Lay the iPad (screen up) on a flat surface.
- 2 Place the iPad Frame Cover on top of the iPad and push down to snap it into place.
- 3 Align the iPad's charging port with the corresponding hole in the Speech Case, then slide the edge of the iPad under the flexible lip at the top of the Speech Case.
- 4 Angle the iPad down to lay flat inside the Speech Case.
- 5 Use your fingers to bend the flexible lip around and over the edges of the iPad.

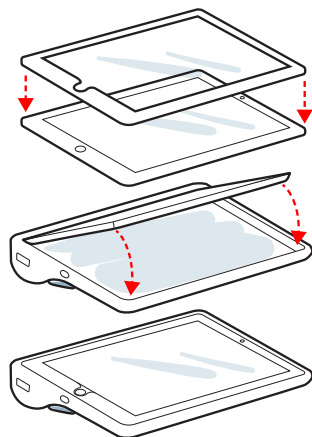

Step 2: Set the Mode

The Speech Case has three modes: Touch (T), iOS Scanning (S), and Off (O). Set the mode on the Access Method Selector **BEFORE** using the device. Use the decision tree to the right to determine the best mode for the user.

i

Touch position (T): The unit will say "Power On" and make 1 click.

Scanning position (S): The unit will say "Power On" and make 2 clicks.

Position (O) is for shipping and extended storage.

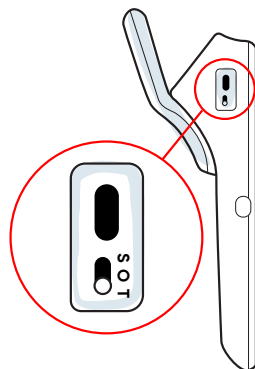

How will the user make selections on the device?

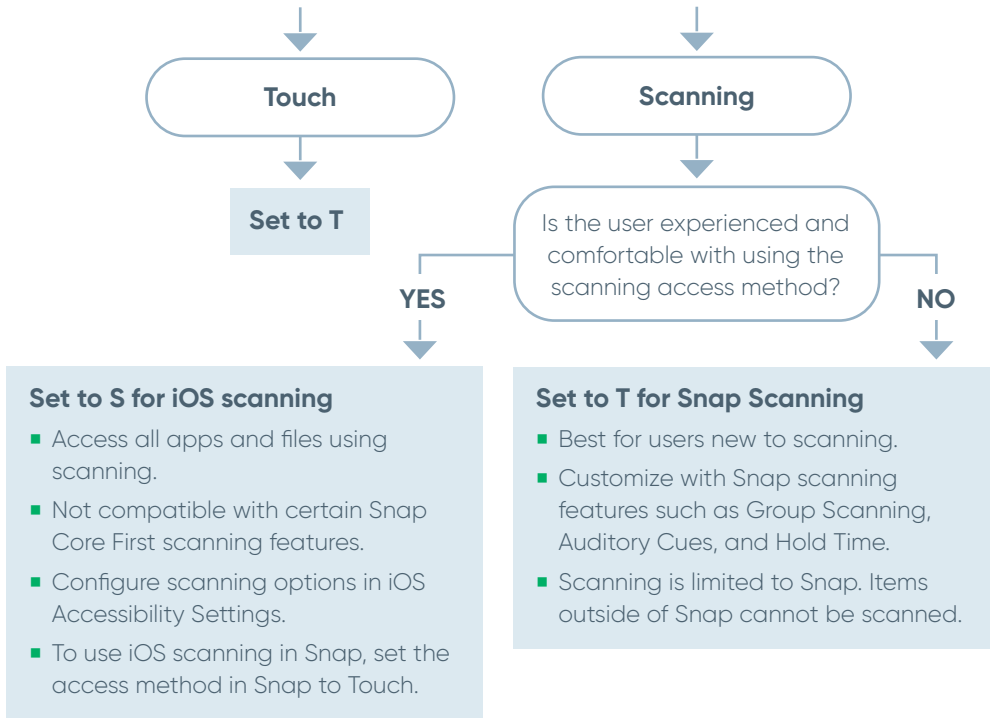

If you need to change the mode, please refer to the Speech Case User Manual.

Step 3: Bluetooth Pairing

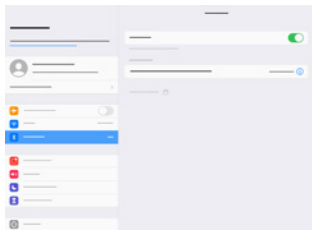

- 1 On the iPad, go to Settings > Bluetooth.
- 2 Make sure that Bluetooth is turned ON.
- 3 Select Tobii Dynavox SC Tablet.



If using multiple SC Tablets in one room, you can identify each SC Tablet by the last five digits of the Bluetooth ID. It will match the unique five-digit serial number located under the built-in stand on the Speech Case.

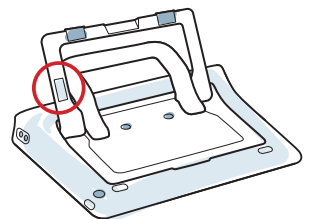

Step 4: Get Started with Snap

Snap Setup Wizard



Launch the Snap Core First app.

Follow the prompts to create your new user, or restore a saved user file.

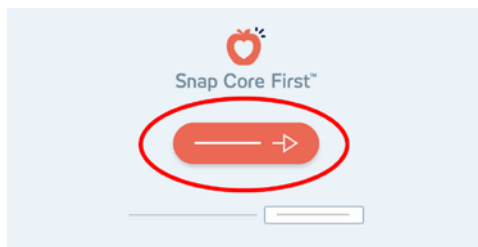

Grid Size

Choose a grid size that provides the most buttons for vocabulary and can be accessed accurately by the user. You can easily change it later.

Access Method

Choose your access method:

- 1 Select **Edit**. 
- 2 Select **User**.
- 3 Select **Access Method**.



Use the Options menu to further customize Touch and Snap Scanning settings. If using iOS scanning, make adjustments in iOS Settings > Accessibility > Switch Control.

Next Steps

Pathways for Core First, a FREE resource, helps teach communication skills using how-to-videos, goals grid, lesson plans and more.

Snap Core First Training Cards contain ideas for everyday use and step-by-step instructions for basic editing. Find them here:



[http://qrco.de/
PathwaysCF](http://qrco.de/PathwaysCF)



[http://qrco.de/
SnapCards](http://qrco.de/SnapCards)



We Are Here to Help



myTobiiDynavox

Use your free account to Sync, share Page Sets, store backups, and more!

Visit: www.myTobiiDynavox.com



Other

Discover Tobii Dynavox App:

<http://qrco.de/TDDiscover>

User Manual:

<http://qrco.de/SCmanual>



Additional Support

Community:

<http://qrco.de/TDFB>

North America Technical Support:

1-800-344-1778 ext. 1

Additional
Speech Case resources
are available here:



[http://qrco.de/
TDSCinfo](http://qrco.de/TDSCinfo)

#PowerToBeYou

Share your Speech Case unboxing and first use
photos and videos with **#PowerToBeYou**.